

SCC LINCOLN CAMPUS
8800 O Street - Lincoln, NE 68520
402-471-3333 or 800-642-4075



STUDENT & ACADEMIC SUPPORT CENTER

- » Academic Success..... 314
- » Admissions.....300
- » Advising.....202
- » Cashier/Student Accounts.....402
- » Financial Aid..... 400
- » Food Pantry.....204
- » Help Desk.....506
- » Registration & Records.....300
- » Student Activities Center.....320
- » Student Support Services.....204
- » Testing Center..... 310
- » Veteran's Center.....524

E = elevator
RR = rest room
D = outside door

DIVISIONS, DEPARTMENTS AND SERVICES

» Accommodations (Disability Services).....204	» Course Restaurant.....D7
» Adult Education..... 413	» ESL (English as a Second Language)..... 413
» Athletics Weightroom.....B28	» GED®..... 413
» Bookstore/Campus Store.....G15	» Gym/Fitness Centers.....O2/O3
» Cafeteria.....G2	» Information Desk★
» Campus Office..... 410	» Learn to Dream Office.....204
» CAPS (Counseling Assistance).....204	» Library..... 2300
» Career Advising Center.....304	» People Obtaining Prosperity (POP).....204
» Career Services (employment).....204	» Safety/Security..... 412
» Child Development Center.....C1	» Shipping/Receiving.....G6/G9
» Coffee Shop (Course Ground).....200	» The Career Academy (LPS).....TCA
» College Administration.....227	» TRIO.....204
» Computer Labs.....R4, 2300	» Virtual Learning..... 518
» Copy Center (Print Shop).....G4	» VOICE (LPS Program).....B25
	» Welcome Center.....304

PROGRAM OF STUDY OFFICES

» Academic Transfer/Arts & Sciences.....V14	» Electronic Systems Technology..... N14
» Accounting/Business/Bus. Comm.....T101	» Geographic Information Systems Tech..... R7
» Automotive Technology..... M1	» Long Term Care Administration..... T101
» Computer Information Technology..... R7	» Office Professional..... T101
» Culinary/Hospitality.....B5	» Technical Skills Instructor..... T5
» Design & Drafting Technology..... T5	» Welding Technology.....K3
» Early Childhood Education..... D9	

LRC (Library Resource Center) 2300
(Above level 300, restroom available)

Can access through doors 7 & 8
Lower level T section..... rooms T1-T12
Lower level U section.....rooms U2-U18
Lower level V section.....rooms V4-V18
(below 227 Administration area)

E = elevator
RR = rest room



SCC ESQ
(Education Square downtown Lincoln location)
1111 O Street, Suite 112 - Lincoln, NE 68508
402-323-3440 or 800-642-4075

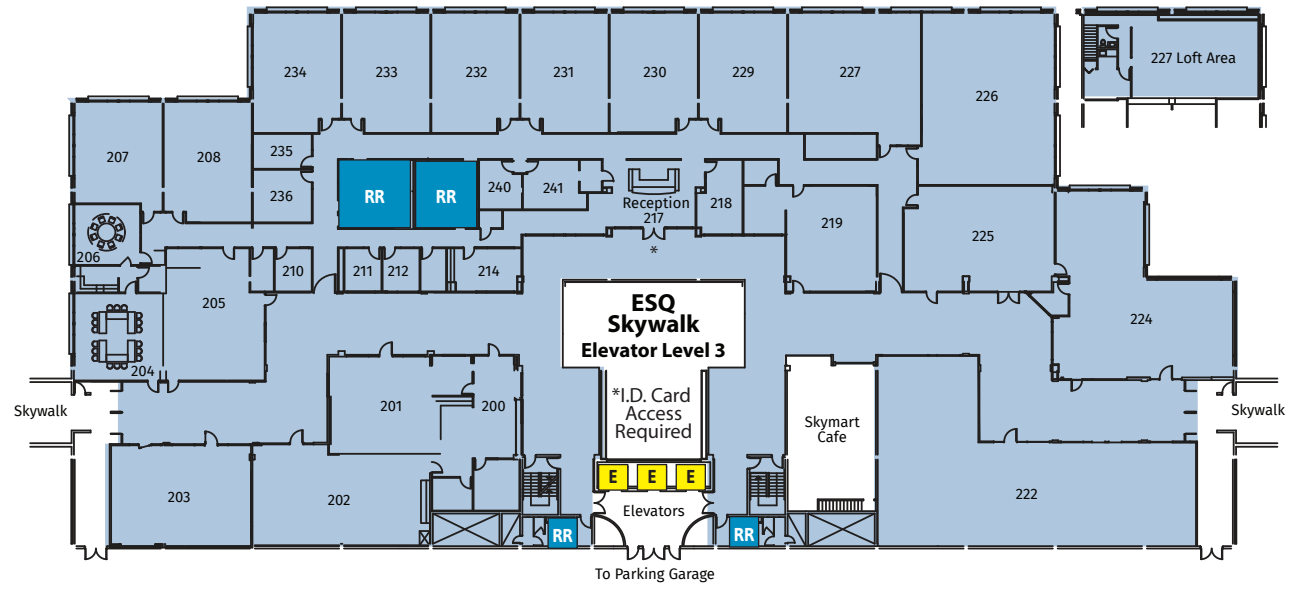
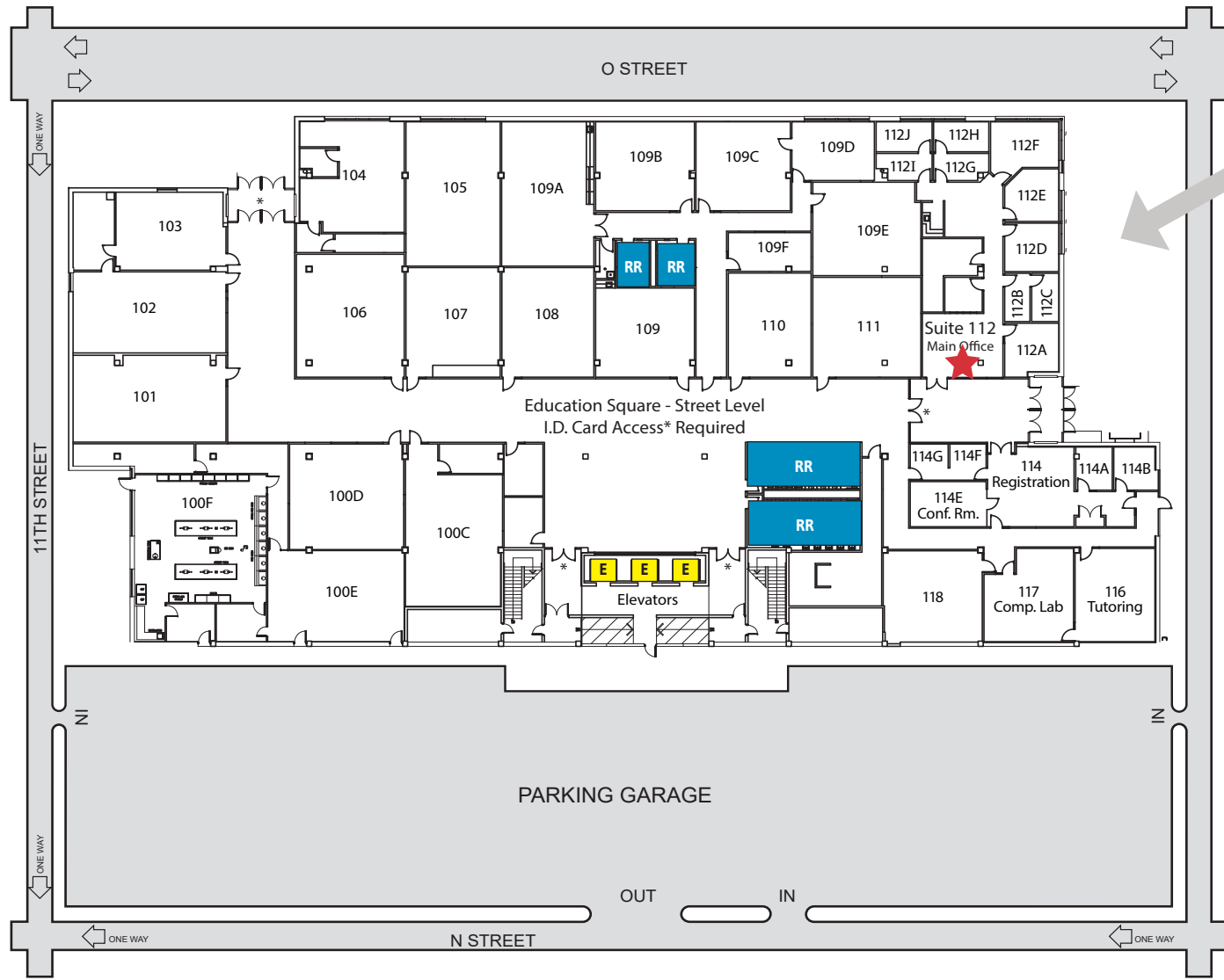

For safety and security, access to ESQ is granted with the use of your ID card only.

- Student Services**
- » Admissions..... 114
 - » Adult Ed. (ABE/GED®/ESL)..... 214
 - » Computer Lab w/ Printer..... 117
 - » Copy Machine..... outside 112
 - » Food Pantry..... 118
 - » ID cards..... 114
 - » **Information/Main Office..... 112** ★
 - » Registration..... 114
 - » Safety/Security Office..... 114F
 - » Student Study Hall..... 118
 - » Transcripts..... 114
 - » Tutoring..... 116

- Program of Study Offices**
- » Academic Transfer 112
 - » Adult & Juvenile Services & Corrections..... 210
 - » Adult Education..... 219
 - » Criminal Justice..... 210
 - » Graphic Design|Media Arts..... 212
 - » Law Enforcement & Homeland Security..... 210

HEATH SCIENCE BUILDING
(ON THE LINCOLN CAMPUS - 8800 O ST.)

- » **Information/Health Main Office..... 230** ★
- » Health Sciences Division Office..... 230
- » Associate Degree Nursing..... 320
- » Dental Assisting..... 220
- » Healthcare Services..... 320
- » Human Services..... 420
- » Medical Assisting..... 220
- » Medical Lab Tech..... 420
- » Paramedic/EMT..... 120
- » Pharmacy Tech..... 420
- » Physical Therapist Assistant..... 420
- » Practical Nursing..... 320
- » Project HELP (grant)..... 120
- » Radiologic Technology..... 120
- » Respiratory Care..... 420
- » Surgical Tech/First Assist..... 120

